

105 B: 3,904 SF

105 C: 1,105 SF

102: 2,496 SF

105 A: 3,215 SF

100: 5,904 SF

GROSS MEASURED AREA: 18,450 S.F.
 VERTICAL PENETRATIONS: 451 S.F.
 FLOOR RENTABLE: 17,999 S.F.
 TOTAL COMMON AREAS: 2667 S.F.
 OFFICE AREAS: 15,135 S.F.



FIRST FLOOR PLAN - WITH PROPOSED TENANT SUITES

SCALE: 1/8" = 1'-0"

5 | JOBS | 2012 JOBS | 01812 - Delta-Corn-Riley-Hutchison | CDS01812 - A1.0.dwg

FUQUA & PARTNERS ARCHITECTS

MEMBER OF THE AMERICAN INSTITUTE OF ARCHITECTS

- Architecture
- Interior Design
- Media Visualization
- Master Planning

100 Church Street, Suite 700
 Huntsville, Alabama 35801
 Phone: (256) 534-3516
 Fax: (256) 533-4605
 www.fuquaarchitects.com

4092 South Memorial Parkway
 Huntsville, Alabama

FIRST FLOOR PLAN - WITH PROPOSED TENANT SUITES

PROJECT NO.	CH20
DRAWN BY	PIER
DATE	March 5, 2012
CHECKED	
FILE NAME	REFER TO BOTTOM LEFT

KEYNOTES

This document is a copyright property of Fuqua & Partners, Inc. and is not to be reproduced or transmitted in any form or by any means, electronic or mechanical, including photocopying, recording, or by any information storage and retrieval system, without the prior written permission of Fuqua & Partners, Inc.



SHEET
A1.0
 OF

ALL SF OF SUITES INCLUDE 20% CAM

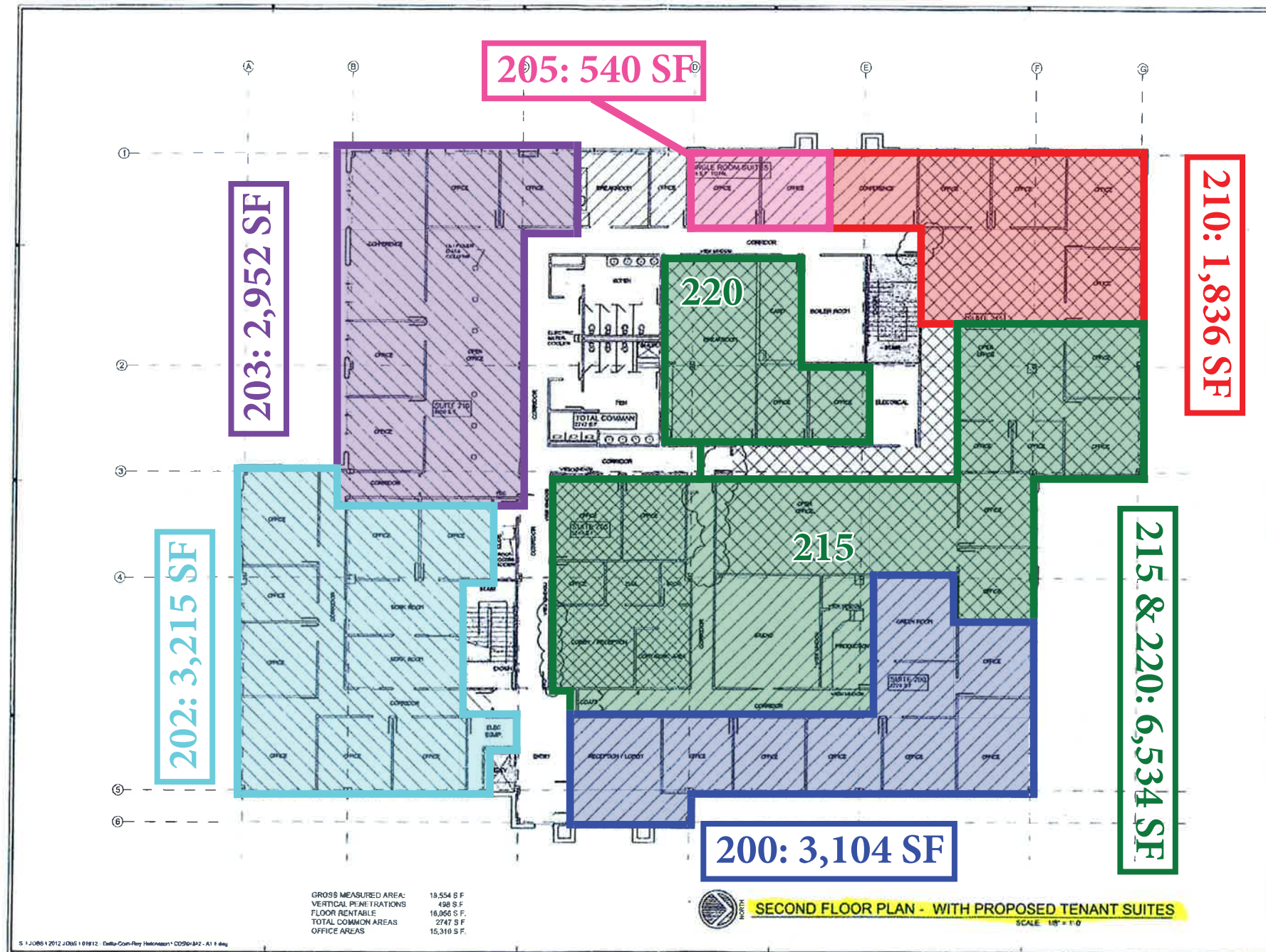

**FUQUA
& PARTNERS**
ARCHITECTS

MEMBER OF THE AMERICAN
INSTITUTE OF ARCHITECTS

- Architecture
- Interior Design
- Media Visualization
- Master Planning

100 Church Street, Suite 700
Huntsville, Alabama 35801
Phone: (256) 594-3510
Fax: (256) 533-4935
www.fuquapartners.com

4092 South Memorial Parkway Huntsville, Alabama	
SECOND FLOOR PLAN - WITH PROPOSED TENANT SUITES	
PROJECT NO:	DATE:
DATE:	PROJECT:
PREPARED BY:	REVISION:

PRELIMINARY
Not For
Construction

SHEET
A1.1
OF

ALL SF OF SUITES INCLUDE 20% CAM